

Parish Magazine of Worksof Priory with Carburton & Clumber



January 2026



£1

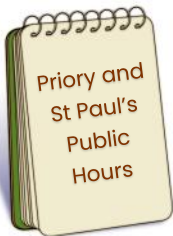

The Parish Office

Applications for baptisms, weddings, etc:

Public Hour: Fridays 10.30am - 11.30am

Our Giving

Bank details for standing orders or donations are:

Workshop Priory Parochial Church Council

Virgin Money Sort Code: 05-09-89

Account Number: 38125853

Due to bank charges for processing cheques and cash, we kindly ask that, wherever possible, people donate money using online banking, even for small amounts. This doesn't cost us a penny. Please indicate in the reference field who it's from, and what for, then we can Gift Aid your donation wherever possible.

You can also donate quickly and easily by scanning our QR code, there is also an option to register to gift aid your donation, it takes a matter of seconds!



Thank you!



Regular Public Worship Times

Sundays

9.30 am Parish Sung Mass with Junior Church
11.30am Mass at Clumber Chapel
6pm Evening Prayer and Benediction (First Sunday)

Monday - Saturday (when possible)

9am Lauds (Morning Prayer)
6pm Vespers* (Evening Prayer)

Daily Mass

| | | |
|-----------|--------|----------------|
| Monday | 9.30am | Mass at Priory |
| Tuesday | 6.30pm | Mass at Priory |
| Wednesday | 9.30am | Mass at Priory |
| Thursday | 6.30pm | Mass at Priory |
| Friday | 12noon | Mass at Priory |
| Saturday | 9.30am | Mass at Priory |



Family Worship

Wednesday 10.15am Songs and Stories for pre-school children and their parents and carers at Priory

Confessions

Thursday 5.45pm at Priory
Friday 11.30am at Priory

vicar@worksoppriory.co.uk

Weddings and Baptisms by appointment. Enquiries to

admin@worksoppriory.co.uk

**On the last Thursday of the month the Rosary replaces Vespers and Mass is offered for the Society of Mary, if no other occasion is being kept that day.*

We aim to make our services as accessible as possible by making the best of the resources available to us across the Parish.

Activities For Children and Young People



All children and young people activities are cross parish ventures putting their joint resources to best use.

Pre-school:

'Songs & Stories', for our youngest [new-born to nursery] and their grown-ups. We meet every Wednesday 10.15 to 11.30am, in Priory Lady Chapel. We have play with soft toys, sound toys, a ball park, picture books and baby gyms followed by story and song.

Please see our Facebook page, 'Workshop Priory Family Page' for updates.

Children of primary school age:

Junior Church for children aged 7-11 on Sundays during the 9.30am Mass.

**RADIANT LIFE
DAY CENTRE**

Kingston Road Community Hub | Kingston Road |
Manton | Worksop S80 2UH
Phone: 07770222509

| radiantlifedaycentre
www.radiantlifedaycentre.co.uk

Where Inspiration Meets Care
Our programmes awaken memory, stir joy,
and calm the soul:

Art & Creative Expression
Colours that heal. Shapes that tell stories.
We paint lives back into motion.

Music & Rhythm Therapy
Familiar songs like lanterns
guiding forgotten emotions home.

Cognitive Stimulation
Puzzles, storytelling, guided conversations—
gentle exercises for the mind's awakening.

Companionship Circles
Because a hand to hold
is sometimes the deepest medicine.

Nature & Movement Walks
Soft breezes. Slow steps.
Moments shaped with tenderness.

Affection-Centered Support
Every interaction infused with love,
every gesture crafted with patience.

JANUARY 2026
**OPENING
in
WORKSHOP**

Registers for December 2025

Baptisms

7th Chester Tingle

Baptisms can be booked each Friday morning at the Priory between 10.30am and 11.30am. If you have queries please email admin@worksoppriory.co.uk



Baptism preparation sessions are held at the Priory on the first Saturday of each month at 5pm.

Funerals

16th Patricia Ann Malkin



Confirmation and First Holy Communions

On **January 4th** Bishop Stephen will be with us to preside at the 9.30am parish Mass and celebrate the Sacrament of Confirmation. Four of our number, Arvie, Dipu, Joshua and Simon will be Confirmed and receive Holy Communion for the first time.



Please make every effort to be present, hold them in your prayers, chat to them, celebrate with them, and be thankful that the Lord is adding to our number with new Christians. Be encouraged in your own faith too.

Bishop Stephen will be delighted to be with us again and meet you. It's be the first off a number of visits, there being the Chrism Mass on Holy Monday (**30th March**) and Fr Garnet's priesting **July 5th**.

January 2026

Dates, Observances and Prayer Intentions

| | | |
|----|---------------------------------|------------------------|
| 1 | Mary, Mother of God | The Parish |
| 2 | SS Basil & Gregory | World Peace |
| 3 | Christmass Feria | Kilton & Larwood |
| 4 | 2nd Sunday of Christmass | The Parish |
| 5 | Christmass Feria | Clumber & Carburton |
| 6 | The Epiphany of the Lord | The Parish |
| 7 | Wednesday after Epiphany | Lowtown & Sparken Hill |
| 8 | Thursday after Epiphany | Our School |
| 9 | Friday after Epiphany | The Town Centre |
| 10 | Saturday after Epiphany | Our Hospital |
| 11 | The Baptism of the Lord | The Parish |
| 12 | Feria | Our Hospice |
| 13 | Feria | The Food Bank |
| 14 | Feria | The Food Pantry |
| 15 | Feria | BCVS |

MONTHLY DEVOTION:

THE HOLY NAME OF JESUS

| | | |
|-----------|------------------------------------|------------------------------|
| 16 | St Antony | Contemplatives |
| 17 | Of Our Lady | Churches Together in Worksop |
| 18 | 2nd Sunday in Ordinary Time | The Parish |
| 19 | Feria | Roman Catholics |
| 20 | Feria | Protestant Christians |
| 21 | St Agnes | Orthodox Christians |
| 22 | Feria | Anglicans |
| 23 | Feria | Bassetlaw District Council |
| 24 | St Francis de Sales | Volunteers |
| 25 | 3rd Sunday in Ordinary Time | The Parish |
| 26 | Feria | Our Government |
| 27 | S Thomas Aquinas | Theologians |
| 28 | Feria | Our Pre-schoolers |
| 29 | Feria | Society of Mary |
| 30 | St John Bosco | Our Teenagers |
| 31 | Of Our Lady | Shrine at Walsingham |

Society Of Mary and Cell of Our Lady of Walsingham

This month our Society Mass of Our Lady will be **6.30pm Thursday 29th January**. The Rosary will be recited at 6pm as part of our prayerful preparation for Mass. All are welcome and guidance can be given to help in this beautiful and effective way of prayer.

Fr Garnett will celebrate his first Mass in the Holy House at Walsingham after his ordination - please let Susan know if you are interested in being with him (July 8th- 11th) so we can reserve rooms at the Shrine.

Thank you.



Fr Spicer writes....

Do you make a New Years resolution? Its never really been my thing, as a family we were too wrapped up in celebrating the 12 days of Christmas and New Year passed us by. As Christians we have Lent and Advent and festivals throughout the year or simply every Sunday which can be new starts, but I can understand that New Year can be helpful in getting one. So, what is my new start to 2026 going to be, what is yours? What are my priorities going to be in the coming months? I'm not going to tell you mine, just as I wouldn't expect you to tell me yours, unless you wanted some advice or support. As we continue to celebrate the great feast of the love of God during these weeks, what are your priorities in response to the Christmas story? We see how the priorities of Our Lady and S Joseph, the shepherds and the wise men are shaped by saying yes to God. Their lives change, their priorities do too because they experience God being born as a human, God in the form of a vulnerable baby. God taking on human form to be one like us to demonstrate His love, a love that is going to lead him ultimately to the Cross.

How does your celebration of Christmas in church, your home, your school, place of work or relaxation demonstrate to God and others that being a Christian is a main priority? There will be others, family, friends, school, work, health and well being, but do they take precedent over the God who loves you?

Like any resolution this takes thought and then hard work, perseverance. Some difficult decisions may have to be made, some compromises. Our Lady and S Joseph were able to be positive and put aside their personal desires, dreams expectations and hopes because they were convinced that the Holy Spirit was guiding and promoting them. They expressed their doubts and fears honestly in prayer and were blessed, and channels of blessings for all, confident that it was the right thing for them to do.

When we act like this then our priorities, our resolutions, will become clear. By placing God and being a serving, worshipping Christian we will find then the other priorities in our lives fall into a natural place too. So in giving the

first few hours of the week on a Sunday to meet with others at Mass; spending a few minutes each day reading my Bible, having a conversation with God; working towards tithing, giving 5% of my income to the church - leaving me with the other 95%; giving something in service; will free us for the rest of the demands of the week and of life.

During this Christmas season may each of us be blessed in God's love as Our Lady, S Joseph, the shepherds and the wise men were, and may our resolutions be to respond to that blessing and be a channel of loving blessing too.

Fr Spicer



“Christmas Bells” by Henry Wadsworth Longfellow

I heard the bells on Christmas Day
Their old, familiar carols play,
And wild and sweet
The words repeat
Of peace on earth, good-will to men!

And thought how, as the day had
come,
The belfries of all Christendom
Had rolled along
The unbroken song
Of peace on earth, good-will to men!

Till, ringing, singing on its way
The world revolved from night to day,
A voice, a chime,
A chant sublime
Of peace on earth, good-will to men!

Then from each black, accursed
mouth
The cannon thundered in the South,
And with the sound
The Carols drowned
Of peace on earth, good-will to men!

And in despair I bowed my head;
‘There is no peace on earth,’ I said;
‘For hate is strong,
And mocks the song
Of peace on earth, good-will to men!’

Then pealed the bells more loud and
deep:
‘God is not dead; nor doth he sleep!’



Parish Visiting

The PCC have set themselves the vision to visit every house in the parish with a leaflet over the next few years. On the last Saturday of the month some of us will gather to leaflet a few roads together. The leaflet will be an introduction to our life here, what we can offer to support someone who wants to lead a Christian life and asking if they would like to come to a Mass to hear someone or something that is on their hearts be prayed for.

If you would like to help deliver leaflets please look out for the next meeting place. Please if possible say a prayer for this endeavour, at around 10.30am, that the homes receiving leaflets will come to know of God's love in the Church.



SAFEGUARDING AT WORKSOP PRIORY

What to do if you have a safeguarding concern:

Urgent concerns

If you believe someone is at immediate risk of being harmed you must contact either the Police or Social Services directly:

Police 999

Nottinghamshire Multi-Agency

Safeguarding Hub (MASH) 0300 500 8090/0300 456 4546

Non-urgent concerns

If the concern is not urgent or an emergency, Worksop Priory has a **Parish Safeguarding Officer – Susan Bekisz**, who manages safeguarding issues at church. She can be contacted on safeguarding@worksoppriory.co.uk alternatively you can call **07355 850735**. This phone cannot always be answered immediately, but you can leave a message. We will endeavour to respond within 48 hours.

There may be occasions when our Safeguarding Officer is not available.

If we have not responded within 36 hours after you have raised a concern, consider the following options to get advice:

Fr Spicer 01909 472180 or 07748 653640

Diocesan Safeguarding Team 01636 817200

Raise funds for us for FREE

with  easyfundraising



Join as our supporter today at:

www.easyfundraising.org.uk/support-a-good-cause

Just search for:

WORKSOP PRIORY

8,000+ retailers will donate to us whenever you shop with them



JOHN
LEWIS



Start at the
easyfundraising
website or app

Click out
to where you'd
like to shop



Checkout:
prices are exactly
the same!

The retailer sends
a % of your spend
to easyfundraising



They pass
it on to us
:)

Plus, you'll get...



Exclusive retailer offers



Competitions



A warm feeling inside!

Over
£60m
raised for UK good causes

£0
extra cost to anyone

Please consider doing your online shopping through the easyfundraising website or app. Currently if you join and shop with eBay by 30 September, Worksop Priory will be entered into the draw to receive one of TEN £500 micro grants. Plus, whenever you buy from eBay or any other participating retailer, Worksop Priory receives a small percentage of the spend as a donation at no extra cost.

All those donations soon add up!

FUNDRAISING FOR PRIORY

We're looking for new and simple fundraising ideas to support our church, and we'd love your help.

If you're able to host a small event—such as a coffee morning at your home—or have any other creative

fundraising suggestions, please let us know.

Every idea, big or small, is greatly appreciated, and your support makes a real difference.

Please give Susan a call on 07355 850735.



Your Parish Monthly Magazine

We are coming to the end of another year of parish magazines for Priory and St Paul's. The production of a full colour magazine on a monthly basis takes both time and money and it is important that we are giving our readers useful and interesting information and articles.

We would love to receive any feedback you may have, along with ideas and suggestions for items you would like to see included.

Subscriptions for 2026 are now due and again we are asking for just £12 for the 12 monthly editions. You will see from the form on page 39 that there are a variety of ways of paying your subscription. Whatever method you use it would be very helpful if you could complete the enclosed form and return it either by placing it in the collection plate, passing it to Fr Spicer, Susan or the Churchwarden, or popping it in the post. This will help us to know how many magazines to print each month.

The magazine and weekly news can also be found our Church Near You website at:

www.achurchnearyou.com/church/17826/news/



WORKSOP COMMUNITY CHRISTMAS TREE FESTIVAL 2025

FINAL UPDATE

Church was transformed with beautifully decorated Christmas trees during the first week of December. Once again, our historic church provided a stunning backdrop for a celebration that brought together creativity, generosity and community spirit in abundance.

Thank you to all the groups who displayed a tree, helping to make the festival such a visual delight. Equal thanks are owed to the many volunteers who gave their time to man the church throughout the week, provide refreshments for visitors, and ensure everything ran smoothly. Gratitude is also extended to everyone who helped spread the word about the festival and encouraged friends, family and neighbours to come along and enjoy it.

This year's visitor vote proved very popular, and congratulations go to the **9th Worksop Brownies & Guides**, whose tree captured the most votes and won the £100 prize. Our sincere thanks go to the generous supporter who donated this prize.

The Christmas Fair, held alongside the festival, was also a great success. Thanks are due to all the stallholders, especially those who raised funds for Priory Church with their efforts. Special appreciation must also go to everyone who helped move church furniture before and after the fair — a vital but often unseen contribution.

Financially, the event achieved remarkable results. The festival raised **£600 in entry fees**, with an additional **£130 in donations** which help cover the costs of hosting the event. The Christmas Fair raised **just over £1,030** for Priory funds.

The Christmas Tree Festival and Priory Christmas Fair were a celebration of community, cooperation and goodwill. Thank you to everyone who played a part in making them such incredible events.



Three Apples from Heaven: A pilgrimage to Holy Armenia.



Have you not asked those who travel the roads, and do you not accept their testimony (Job 21:29)

When telling some friends and family that I had planned to go to Armenia in October two incredulous responses always seemed to arise, why and where is it? Once I had explained that the purpose of my trip was to visit the country's churches and holy sites they seemed to be satisfied in my explanation, whilst still remaining bemused regarding the country's exact location. My stock response to the geographical questioning became routine, 'east of Turkey, south of Georgia, west of Azerbaijan and north of Iran.' Landing in the capital Yerevan late in the evening doesn't provide you with a clear aspect of the city but keeps you on tenterhooks for the following day.

To understand contemporary Armenia, one must try to engage with it's past. Otherwise it can be perceived as a threadbare satellite state of the former Soviet Union that acquired it's independence in 1991. As the author and chef Anthony Bourdain wrote, 'Armenia remains a dream, a subject of stories; it is still, against all odds, a place.' What is meant by this is that many Armenians talk about 'Historical Armenia' compared to what contemporary Armenia actually is today. For example Mount Ararat, an intrinsic symbol of Christianity and Armenian identity which looms over



the capital is actually in modern day Turkey, a country Armenia shares a closed border with. The lights that shine on Ararat at night are not rustic mountain villages but Turkish military bases reminding Armenians of both their territorial and spiritual loss. A similar story is replicated on Armenia's closed border in the

east with Azerbaijan as a result of the disputed area of Nagorno-Karabakh. Interestingly it is Iran, out of all the non-Christian neighbours, that Armenia shares the best diplomatic relationships with. Recently in Tehran a newly installed metro station named Holy Mary was opened, dedicated to the Armenian Christian community. Hope springs in the strangest of places.



The holy sites that I visited ranged from those founded in the 4th century to the more contemporary ones which were consecrated in 2001. The Mother See of Holy Etchmiadzin which was begun by St. Gregory the Illuminator in the early 4th century is located in the city of Vagharshapat and is the spiritual, cultural and administrative centre of the Armenian Apostolic Church. It is an extended site which possesses numerous churches within an enclosed environment. The complex is the hub of the Armenian Apostolic Church and to some extent sets the tone for the design and architecture of all the other holy sites within the country. Although relatively new the St. Gregory the Illuminator cathedral in Yerevan is again in a typical Armenian architectural style. This cathedral is a huge cavernous place which can hold upwards of 1700 people and is built from, like many prestigious Armenian buildings, tufa stone.

Armenian church architecture has its origins in the 4th century when the country became recognised as the first nation to formally adopt Christianity as its national religion. Although Armenian churches possess subtle differences in style they are not as pronounced as what you would see in the development of English church architecture for example. The stylistic variants



in the churches can essentially be described as the following, basilica, cruciform, radial and circular. However it is not the nuances of architecture that are the overwhelming feature of the Armenian churches it is their stunning locations, atmosphere, tranquility and most of all their enduring spirituality. The role these buildings play in Armenian life is central. During an early morning walk around Yerevan I was astonished to see so many people, young and old, making the sign of the cross as they passed the nearby church of St. Astvatsatin on their way to work, college or school.



So what did I experience from my time in an overtly Christian county? Yes I went to many holy sites which I don't have the time to cover here and a fleeting insight into a nation that clearly suffered so much historical trauma and endures considerable contemporary uncertainty, but the welcome was both genuine and wholesome.

On a personal note I had never been on an extended pilgrimage before especially with a group of people who were unknown to me. Also as a solo traveller there were a number of legitimate anxieties that were present before the trip, however these were vanquished by the time I returned home.

Our group was made up of different denominations of Christians and that was a blessing in itself, as it provided differing perspectives on many issues and how we approached our own faith and beliefs. Pilgrimage, wherever and with whoever, seeks to heal our mind, body and soul, and connects us to places, communities, sites, history and landscapes, whilst enriching our lives through the spiritual sentiments they evoke. Armenia did for me all of this and more, and so next year I will return back to the Caucasus region travelling further north to Georgia.



By Gavin Glasby





Children's Liturgy

Every Sunday

Priory Church 9.30am



Speak, Lord

S.D.C.
SOCIETY FOR
DOCTRINE
CHRISTIANITY
www.sdc.me.uk

Ecclesiasticus 3:2-6, 12-14
Psalm 127
Colossians 3:12-21
Matthew 2:13-15, 19-23

SUNDAY LITURGY FOR CHILDREN

Year A — Holy Family



Put these letters in order to reveal today's feast.

M H Y Y L F O A I L

I am Mary,
Jesus' Mum.

I am Joseph,
Mary's
husband.

I was worried about
Jesus but we were
safe in Egypt.

The angel told me to
take Jesus and
Mary to Egypt
because Herod
wanted to kill Jesus.



**AFTER THEY RETURNED
FROM EGYPT JESUS AND
HIS FAMILY LIVED IN**

NAZARETH

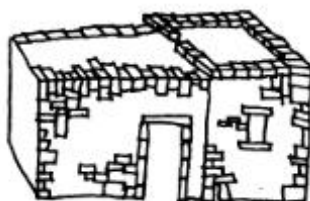



Ecclesiastious 24:1-2.8-12
Psalm 147
Ephesians 1:3-6.15-18
John 1:1-18

Speak, Lord

S.D.C.
SOCIETY OF
DISCIPLES
CHRISTIAN
www.sdc.me.uk

SUNDAY LITURGY FOR CHILDREN

Year A — 2nd Sunday after Christmas



Colour in the name of Jesus and draw his picture in the circle.

JESUS
THE SON OF GOD
WAS BORN
AND LIVED AMONG US

Fill in the missing letters to reveal the meaning of this sentence:

THE WORD

was made

J _ _ _ _

became

FLESH

A H _ _ _ _

B _ _ _ _



Isaiah 60:1-6
Psalm 71
Ephesians 3:2-3, 5-6
Matthew 2:1-12

Speak, Lord

S.D.C.
SOCIETAS
DOCTRINAE
CHRISTIANAE
www.sdc.me.uk

SUNDAY LITURGY FOR CHILDREN

Year A — 6 January — The Epiphany of Our Lord



THE WISE MEN FOLLOWED THE S _____ TO FIND J _____



Colour in their 3 Gifts

GOLD



FRANKINCENSE



MYRRH





Isaiah 42:1-4,6-7
 Psalm 28
 Acts 10:34-38
 Matthew 3:13-17

Speak, Lord

S.D.C.
 SUNDAY
 DOWNSIDE
 CHRISTIAN
 www.sdc.me.uk

SUNDAY LITURGY FOR CHILDREN

Year A — 1st Sunday in Ordinary Time — The Baptism of the Lord



JESUS BAPTISED IN THE RIVER



Use the following code to reveal what God's voice said when John baptised Jesus.

| | | | | | | | |
|---|---|---|---|---|---|---|---|
| 1 | 2 | 3 | 4 | 5 | 6 | 7 | 8 |
| H | I | M | N | O | S | T | Y |

GOD SAID:

“ 7 1 2 6 2 6 3 8 6 5 4 ”

January Puzzle Page

| | A | B | C | D | E | F | G | H | I | J | K | L | M |
|----|----|----|----|----|----|----|----|----|----|----|----|----|----|
| 1 | 5 | 21 | 11 | 20 | | 10 | 21 | 25 | 12 | 22 | 21 | 23 | 8 |
| 2 | 19 | | 21 | | 8 | | 23 | | 20 | | 9 | | 8 |
| 3 | 1 | 13 | 22 | 6 | 20 | 5 | 24 | | 24 | 1 | 9 | 2 | 5 |
| 4 | 20 | | 6 | | 12 | | 4 | | 21 | | 25 | | 21 |
| 5 | 21 | 8 | 8 | | 15 | | 20 | | 14 | 15 | 1 | 23 | 8 |
| 6 | 12 | | | | 23 | 7 | 12 | 14 | 4 | | 20 | | 11 |
| 7 | 6 | | 6 | | 5 | | | | 7 | | 8 | | 21 |
| 8 | 5 | | 23 | | 24 | 1 | 18 | 20 | 5 | | | | 23 |
| 9 | 4 | 6 | 2 | 20 | 25 | | 20 | | 8 | | 20 | 21 | 24 |
| 10 | 23 | | 26 | | 21 | | 4 | | 9 | | 17 | | 21 |
| 11 | 20 | 3 | 20 | 9 | 24 | | 21 | 12 | 21 | 18 | 6 | 23 | 13 |
| 12 | 5 | | 22 | | 20 | | 22 | | 22 | | 22 | | 20 |
| 13 | 5 | 15 | 22 | 6 | 8 | 6 | 10 | 7 | | 10 | 20 | 1 | 8 |
| | A | B | C | D | E | F | G | H | I | J | K | L | M |

| | | | | | | | | | | | | |
|---|---|---|---|---|---|---|---|---|----|----|----|----|
| 1 | 2 | 3 | 4 | 5 | 6 | 7 | 8 | 9 | 10 | 11 | 12 | 13 |
| | | | | | I | | | | | | | G |

| | | | | | | | | | | | | |
|----|----|----|----|----|----|----|----|----|----|----|----|----|
| 14 | 15 | 16 | 17 | 18 | 19 | 20 | 21 | 22 | 23 | 24 | 25 | 26 |
| | | B | | | | | | | | | | |

Enter the letter in each circled cell in the order given below to reveal a themed answer:

| | | | | | | | | | |
|----|----|----|----|-----|----|----|-----|----|----|
| 1H | 9G | 1C | 9K | 12K | 9L | 3I | 13D | 5J | 2G |
| | | | | | | | | | |

Epiphany Blessing of Chalk

The Church has a custom of blessing homes on the Feast of the Epiphany (January 6th) and the week following. Family and friends gather to ask God's blessing on their homes and those who live in or visit the home. It is an invitation for Jesus to be a daily guest in our home, our comings and goings, our conversations, our work and play, our joys and sorrows.

A traditional way of doing this is to use chalk blessed during the Epiphany liturgy and write above the home's entryway, 20 + C + M + B + 25. The letters C, M, B have two meanings. They are the initials of the traditional names of the three magi: Caspar, Melchior, and Balthazar. They also abbreviate the Latin words *Christus mansionem benedicat*, "May Christ bless the house." The "+" signs represent the cross and 2025 is the year.

Using the blessed chalk mark the lintel of your front door (or front porch step) as follows:

20 + C + M + B + 25

While saying:

The three Wise Men, Caspar, Melchior, and Balthazar followed the star of God's Son who became human two thousand and sixteen years ago. May Christ bless our home and remain with us throughout the New Year. Amen.

Then offer the following prayer:

Visit, O blessed Lord, this home with the gladness of your presence. Bless all who live or visit here with the gift of your love; and grant that we may manifest your love to each other and to all whose lives we touch. May we grow in grace and in the knowledge and love of you; guide, comfort, and strengthen us in peace, O Jesus Christ, now and for ever. **Amen**



Some Facts about our Parish ...

In October, as part of my curacy training, I gave a presentation to the other deacons of the Diocese of Southwell and Nottingham on the context of ministry in the Priory parish and Carburton.

The statistics are quite interesting, although, as ever, they can be misleading. For instance, in terms of land area, because of Carburton and Clumber Park, we count as a mainly rural parish, which may come as a surprise to many! Obviously, most of the population lives in an urban or suburban setting.



St Anne's, Newcastle Avenue

That said, there are some more useful things to be learned. According to the 2021 census, Worksop as a whole has a population of 44,733 and this parish is home to 9,534 people, living in 4,234 households. That tells how many leaflets we need to deliver! It also tells us that a high proportion of people live in single-person households – 36%. The parish is overwhelmingly white in terms of ethnicity (95%) with Asian, mixed and black ethnicities all below 2%. Almost half (45.6%) of the population is over the age of 45 and 20% over 65. However, 21.6% are under 20 and 4.7% are under the age of 5.

In terms of the rate of deprivation, of the 12,161 parishes Of the Church of England, Worksop Priory with Carburton is



Christchurch, Thievesdale



St Luke's, Shireoaks

ranked 919th most deprived (where 0 = the most deprived) according to current Church of England information based on the 2021 census.

For comparison, within Worksop:

| | |
|----------------------------|------------|
| St Paul's, Manton | 395 |
| Priory w. Carburton | 919 |
| St John's | 2409 |
| St Anne's | 5040 |
| Christ Church w. Shireoaks | 6532 |

You can see there's quite a deal of inequality within the town.

According to the Church Urban Fund,
21% of children are living in poverty.
19% of pensioners living in poverty.
18% of working-age people living in poverty.

Other indicators of deprivation are:
29% of residents have no educational qualifications.
20% of residents are 65 or older.
27.1% of residents live in social housing.
7.3% of households with children are lone-parent families.
36.1% of residents live alone.

When it comes to religion, 56.2% of people in the parish declared themselves to be Christian in the 2021 census. Wouldn't it be wonderful if they all came to church! Only 1.9% were of other religious backgrounds, but 36.1



St Paul's, Manton



St John's, Overend Road

per cent of people said they had no religion, and this figure has grown considerably since 2011.

I hope this gives some insight into the context in which we minister. We are in a parish that has a large proportion of elderly people compared to young, where a high proportion of people live alone and many live in poverty. We also face the challenge of growing indifference to religion and so our mission to proclaim the Good News of Jesus Christ in our own streets and neighbourhoods is more important than ever.

By Fr Garnett



Worksop Priory, Priorswell Road



Clumber Chapel, Clumber Park

Church Decorations

Thank you to everyone who contributed financially to this years Christmas decorations - Church looks lovely. It's not too late to make a donation for the flowers and trees. Please place it a marked envelope for the plate or make a bank transfer stating "flowers" or use the contactless machine.

Thank you too to those who did the decorating but especially to Carol, David, Myra, Stella and Wendy. After numerous years in this ministry, and it is a ministry as much as reading or serving is, they have decided to hang up their sectors and "retire". We are most grateful for all the work they have done.

This means that we have some decisions to make and it'd be a shame if not having any flowers was one of them. Please have a word with James or Fr Spicer if you think you would like to take responsibility, for a flower arrangement in the Lady Chapel, or sanctuary, or be prepared to help at festival time.

Thank you.



Christian Unity Week

The Week of Prayer for Christian Unity (WPCU) takes place each year from 18 to 25 January. This ecumenical celebration provides an opportunity to focus our prayers on Christian unity and to know that we are joining with international siblings in Christ. WPCU is also a great chance to speak about and experience Christian unity personally, in your village, town or county.

This year WPCU takes Ephesians 4 v 1-13 as its central text which includes the words “There is one body and one Spirit, just as you were called to the one hope of your calling.” (Ephesians 4:4). The World Council of Churches prayers and reflections for WPCU 2026 have been prepared by the faithful of the Armenian Apostolic (Orthodox) Church, along with their brothers and sisters of the Armenian Catholic and Evangelical Churches. These resources draw upon centuries-old traditions of prayer used by the Armenian people, along with hymns that originated in the ancient monasteries and churches of Armenia, some of which date as far back as the fourth century.

More details can be found at <https://cte.org.uk/wpcu2026/>

Do you have a family member or friend who worships in a different Church? Can you meet up with them this month to talk about these things? Maybe visit one of their services or invite them to join you in one of ours?

May we all play our part in fulfilling the prayer Our Lord made in the Garden of Gethsemane “ May they all be one”

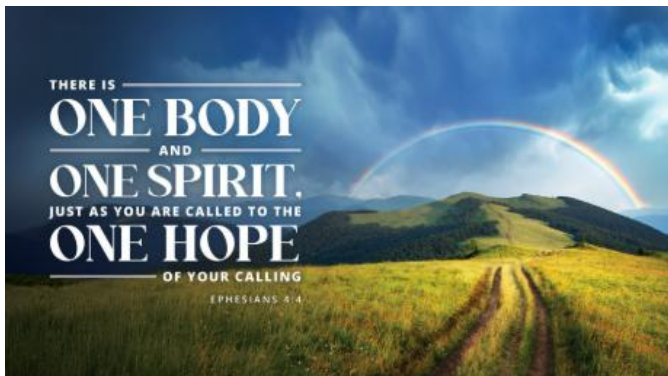

'My Favourite Hymn'

There are many beautiful hymns which I enjoy singing and listening to. The one which keeps me uplifted, and kept coming to mind as I was deciding, is **Soul of my Saviour**.

The words speak for themselves, I think, of what is now, what was promised, and what is to come. It provokes so many emotions depending on our needs and hopes.

We sang this at my Dad's Funeral Mass in 1999 and again for my Mum's in 2017. She wanted the same hymns as Dad had chosen. God bless them.

Wendy Klonowski

We really enjoy hearing about how hymns have influenced your lives and what they mean to you as you share your thoughts and memories.

If you have a favourite hymn and are happy to share it with us, we would love to hear from you.

Please contact Susan at admin@worksofapriory or have a chat with Ginny Darby.

"Soul of my Saviour"

Soul of my Savior, sanctify my breast;
Body of Christ, be thou my saving guest;
Blood of my Savior, bathe me in thy tide;
Wash me with water flowing from his side.

Strength and protection may thy Passion be;
O Blessed Jesus, hear and answer me;
Deep in thy wounds, Lord, hide and shelter me;
So shall I never, never part from thee.

Hear me, Lord Jesus, listen as I pray;
"Lead me from night to never ending day.
Fill all the world with love and grace divine,
And glory, laud, and praise be ever thine."

Source: [Breaking Bread \(Vol. 39\) #196](#)



Worksop Priory Annual Raffle

There is still time to help sell as many raffle tickets as possible before the draw on **Sunday 4 January**.

As well as the cash prizes we have had hampers of festive goodies and treats donated by **Morrisons, Aldi, Tesco and Iceland**, as well as vouchers for local businesses including **Miss Poppy's Coffee Shop** in Eyre's.

Many thanks to Gary Kyriacou who has done an amazing job of approaching businesses and co-ordinating the donations.

Now let's try and raise as much as possible by selling as many tickets as we can to raise funds for the upkeep of our beautiful church!

WORKSOP PRIORY

**NEW YEAR
PRIZE DRAW**

1st Prize £75
2nd Prize £50
3rd Prize £25

...plus many other prizes...
please help sell as many tickets as possible!

To be drawn after Mass
Sunday 4th January 2026

Rosemary writes...

It's good, from time to time, to take stock of where we are and to consider where we're heading. In a parish church, the state of the music depends on what is wanted, what is possible with the people in question, and what is done about training them up to deliver it. Many churches have a mixed economy with formal and informal styles of music serving particular needs, which can be divisive or it can be very healthy because there is no monopoly. Another factor is just how big the catchment is from which volunteer musicians can be drawn. There are some surprises in that, too: a place with few transport options and little money for going away may well find it has a better set of "staffers" for the church, than in an affluent and well-connected place. It was twenty-five years ago that a rural Vicar in deepest Hampshire asked me if I knew what the "enemy of the Gospel" looked like in his deanery? I made some irritating reply to the effect that there were a few I knew of, but I hesitated to name them. He said, No, it's yachts and horses. Always got something "better" to do, and that means sailing or riding, neither of which is a cheap pastime and all of which seem to converge on Sunday mornings. It was just becoming normal to regard church as a last-resort if there was nothing more exciting/interesting on offer. And working to recruit children and teens to church music in that climate was both exhilarating (there are many from that cohort still serving faithfully who do not fit the stereotype of yachts and horses one iota) and it was worrying, as we all saw the leaching away of the sense of priority which, if you profess to believe, you might expect would be given to the things of God.



Here in Workop we have a faithful choir nucleus and I am still trying to expand that into something which is sustainable into the longer-term future. Training up a new singer from nothing is not a speedy process if you want to keep singing the sort of thing we do at present. That is not a problem, provided you can nab them for training. But any vol-

untary choir needs to keep recruiting to manage retirements and enrolments so that there is never a complete gap in the provision. It was numerically similar in 2021 when I joined, though the traffic has been 7 joiners and 3 leavers – so loosely similar in overall result. Another factor is that a full provision of voice-parts, not just of people who sing, is needed to keep the repertoire happening. Someone once said to me that they thought everyone learnt the same tune, and the difference in their voice-ranges produced the harmony. If only! It takes mental independence to “hold a line” as we say, and that is where training counts for so much.

The instruments are a valuable and sometimes expensive-to-run asset. The organ has suffered from mechanical problems pretty much since it was built, to judge from all the papers. The topic is now before the PCC and there is a will to investigate further and see what might be done. Tiny detail, but for ages the upright piano had one broken castor and three that did a “Tesco trolley” thing in the wrong direction at any attempt to move it; it was a pest for the school when visiting, and that is now cured with four co-operative castors with brakes on them, too (!) The funding for that has come from Midday Music, which is in the black due to the generosity of the collection, and to some extent the mean-ness of yours truly, though that needs to be balanced against decent expense-payments to long-distance performers (who incur loss of earnings as well as direct travel costs, on our behalf). The Performing Rights Society has a tariff to which we are obliged to subscribe for concerts (not for worship) and that too comes from the same collection. When there are savings to be made, there is always the question of whether cuts reduce income faster than they save outgoings. The good news with MM is that, so far, it is balancing well. A float is needed to start the new season – the grand piano always needs regulating after a winter in the North Transept, and the series takes a few weeks to get going with a full audience momentum. Lots more to do, but some progress too.

Rosemary Field
Director of Music





Worksop Priory C of E Primary Academy



Welcome to Priory Nursery and Reception



Our Nursery Times are:

Morning – 8:30am to 11:30am

Afternoon – 12:30am to 3:30pm

We are also able to offer 30 hrs by application



We offer some fun groups to attend *with your little one*, either before your child starts with us or once they are at Nursery.

Playgroup @ Priory Nursery

Activities, dancing, stories and rhymes for the under 5's. Every Monday
1.15 – 2.15pm.

Family Fitness

Action activities with stories and rhymes for the under 5's. Tuesday 3.30-4:15pm. Runs for six weeks each term, please contact the office for dates.

Wiggly Worship at Priory Church

For the under 5's (pram service), every Wednesday 10.15-11.15am.



We look forward to seeing you!

Contact the Academy Office on 01909 478886

Or email office@worksoppriory.snmat.org.uk



The Hundred Club



If you are new to Worksop Priory you may not know that this is one of our main fundraising enterprises. We are incredibly grateful to Ivy Underwood who set up the venture and managed it incredibly successfully for many years. The funds have been used to refurbish several areas of church and we hope to be able to continue this into the future.

The cost remains at just £1 per week per number with weekly prizes of £20, £10 and 2 x £5. Twice yearly there is an extra £100 prize and at our Christmas Fair we hold a draw for a £500 prize.

We still have numbers available, and it would be fantastic if we could get subscriptions for all 100 numbers in place. It would make a huge difference to the proceeds generated and in turn aid the decision making process regarding improvements to church that could be made.

AVAILABLE NUMBERS

29,32,34,59,61,62,63,74,50,82,84,86,89,91,92,96,97

Subscription Information:

Each number is £1 per week and to make this enterprise simpler to manage we please ask that subscriptions are paid as follows:

- ☒ by bank transfer and referenced '100 CLUB'.
- ☒ Cash/cheque (pay to: "Worksop Priory PCC") payments should be in an envelope clearly marked '**100 CLUB**' with your **NAME** and **NUMBER**.

Envelopes can be placed in the collection plate or passed to a member of the clergy, Keith Wake or Susan Bekisz.

**If you would like to join the 100 Club, or if you would like another number please contact Susan either at:
admin@worksoppriory.co.uk
or on 07355 850735**

Thank you for your support!



YOU ARE INVITED TO
JOIN US FOR

Christmas Lunch

Worksop Priory
Sunday 28th
December 2025

12.30pm

Traditional Turkey Dinner &
Christmas Pudding
£8

Please add your name to the list at the
back of church.

See you there





| | | |
|-------------------------------|--|------------------------------|
| Episcopal Visitor | The Rt Revd Stephen Race office@seeofbeverley.org.uk | 01924 250781 07930 096642 |
| Vicar | Fr Nicolas Spicer The Vicarage Cheapside, Worksop S80 2HX vicar@worksoppriory.co.uk | 07748 653640 01909 472180 |
| Assistant Curate | Fr Robert Garnett 6 Conrad Close Worksop S80 2EN | 07508 425157 |
| Honorary Assistants | Fr Martyn Jarrett Fr John Willett | |
| Priory Safeguarding Officer | Susan Bekisz admin@worksoppriory.co.uk | 07355 850735 |
| Priory Churchwarden | Mr James Rubie warden@worksoppriory.co.uk | 07967 567283 |
| Priory Treasurer | Mr Keith Wake treasurer@worksoppriory.co.uk | 07500 781759 |
| Priory Secretary | Mr Robin Carrington– Wild robincarringtonwilde@gmail.com | 07808 651123 |
| Priory Business Administrator | Susan Bekisz admin@worksoppriory.co.uk (Mon, Tues, Thurs and Fri) | 07355 850735 |

| | | |
|-----------------------------------|---|------------------------------|
| Priory Guides and Brownies | Mrs Kirstie Pogson | 07775 742122 |
| Health & Safety Representative | Rob Thistlethwaite robert_thistlethwaite@hotmail.com | 07973 452781 |
| Priory Director of Music | Rosemary Field rosemaryfield@rmfield.co.uk | 07726 239420 |
| Additional Curates Society | Mrs Chris Palin | 01909 500737 |
| Priory School | Mr Kevin Houghton (Headteacher) Holles Street, S80 2LJ | 01909 478886 |
| Priory Gift Aid Secretary | Mrs Kate Walters | 01909 480283 |
| Priory Bell Ringing Tower Contact | Edward Bennett eathbennett@gmail.com | 07943 974407 |
| Junior Church | Mrs Mary Howe | 01909 779779 07828 453388 |
| Priory Flower Arranger | Mrs Wendy Caseldine | 01909 475934 |
| Mother's Union | Fr Spicer | 01909 472180 |
| Society of Mary | Mr Graham Hutchinson | 07588 807943 |
| St Paul's Community Food Pantry | Matthew Marshall-Watson stpaulmanton@gmail.com | |
| Priory Web Manager | Vacant | |



For most up to date shopping lists see the weekly newsletter or go to

www.facebook.com/

There is a donation box by the South Porch entrance at Priory

[www.justgiving.com/](http://www.justgiving.com/bassetlawfoodbank)

bassetlawfoodbank

PUZZLE SOLUTION



Keyword: REVELATION

Entering Heaven

Three men died on Christmas Eve and were met by Saint Peter at the pearly gates.

"In honour of this holy season," Saint Peter said, "You must each possess something that symbolises Christmas to get into heaven."

The first man fumbled through his pockets and pulled out a lighter. He flicked it on. "It represents a candle," he said. "You may pass through the pearly gates," Saint Peter said.

The second man reached into his pocket and pulled out a set of keys. He shook them and said, "They're bells." Saint Peter said, "You may pass through the pearly gates."

The third man started searching desperately through his pockets and finally pulled out a pair of women's glasses.

St. Peter looked at the man with a raised eyebrow and asked, "And just what do those symbolize?"

The man replied, "They're Carol's."



Looking Ahead...



December

| | |
|----------|---|
| Sat 27th | Fundraiser; Vicarage Coffee Morning (10.30am-12.30pm) |
| Sun 28th | Carols in St Cuthberts Chapel (12noon) |
| Sun 28th | Christmass Parish Lunch at Priory (12.30pm) |

January

| | |
|-----------|---|
| Thurs 1st | Mary Mother Of God, Mass at Priory (12 noon) |
| Sun 4th | Confirmation & First Holy Communion Mass with Bishop Stephen (9.30am) |
| Tue 6th | Epiphany, Mass at Priory (6.30pm) |
| 18-25th | Week of Prayer for Christian Unity |
| Tue 27th | Priory PCC Meeting (6.30pm) |
| Thu 29th | Society Mass of Our Lady 6.30pm (Rosary from 6pm) |

March

| | |
|----------|--|
| Mon 30th | Chrism Mass with Bishop Stephen (12noon) |
|----------|--|

July

| | |
|--------|--------------------------|
| 5th | Fr Garnett Ordination |
| 8-11th | Pilgrimage to Walsingham |

February Magazine

Please send articles or news for the
February 2026 magazine to

admin@worksoppriory.co.uk

by **Friday 16th January** at the latest.

Unfortunately we can't guarantee inclusion of articles
received after this date.



Parish Magazine Subscription 2026



| | |
|--|---|
| Name | |
| Address (inc postcode) If postal subscription | |
| Subscription Type | <input type="checkbox"/> £12 for 12 magazines <input type="checkbox"/> £24 for 12 postal magazines |
| Payment Type | <input type="checkbox"/> Cash enclosed <input type="checkbox"/> Cheque enclosed <input type="checkbox"/> Bank Transfer Workop Priory PCC: Virgin Money Sort Code 05-09-89 Account Number 38125853 Leave MAGAZINE as reference <input type="checkbox"/> In Church Card Machine |

Please return this form to The Administrator, Priory Vicarage, Cheapside, Workop, S80 2HX

or

Leave in an envelope labelled 'Magazine Subscriptions 2026' with a member of the clergy,
Churchwarden, or place in the collection plate.



Mass Times

Sundays

9.30 am Parish Mass with Junior Church at Priory

11.30am Mass at Clumber Chapel

6pm Evening Prayer and Benediction at Priory
(First Sunday)

Email:

vicar@worksoppriory.co.uk warden@worksoppriory.co.uk
admin@worksoppriory.co.uk treasurer@worksoppriory.co.uk

Web:

worksoppriory.co.uk
achurchnearyou.com/st-mary-st-cuthbert-worksop-priory

Safeguarding matters please contact:

Parish Safeguarding Officer:

admin@worksoppriory.co.uk 07355 850735

Diocesan Safeguarding Team:

safeguarding@southwell.anglican.org 01636 817200

Priory CCLI No : 244298